



# LONDON NEIGHBOURHOODS **GREENWICH**

Sample itinerary

**LONDON**  
CONVENTION BUREAU

# Greenwich

Greenwich is one of the three royal boroughs in London, situated on the southern banks of the river Thames.

Home to a UNESCO World Heritage site, a royal park, a planetarium, one of the world's most popular music venues and more, Greenwich is a truly unique and buzzing place to host business events.



# In the wider context of London

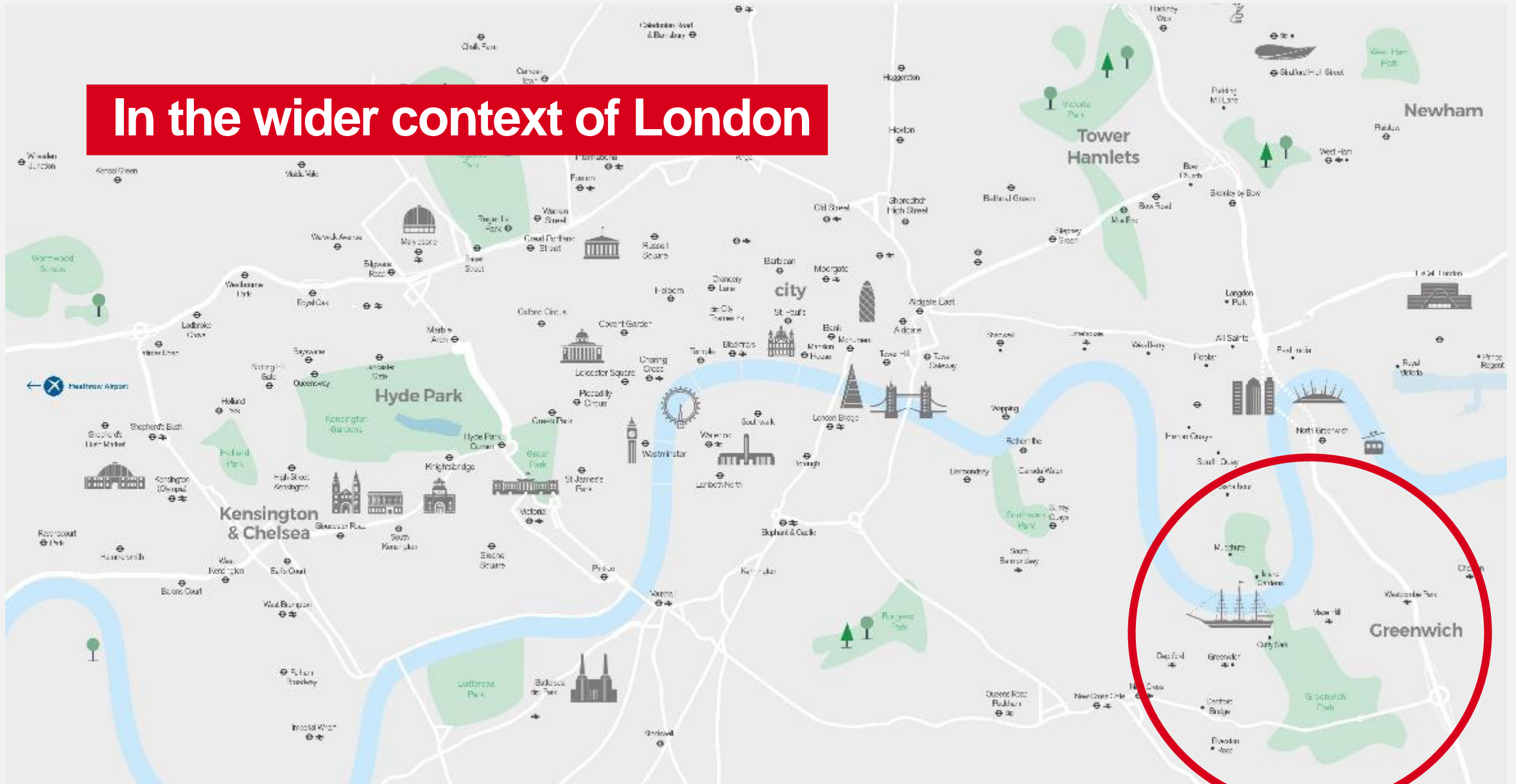

## Getting here:

London City Airport is one of six international airports in London and is located right at the centre of the capital.

The airport's location is a vital aspect for business travellers, with ExCeL London, Canary Wharf and Greenwich all being in close reach. The departure lounge is also designed for the business traveller, with free wifi, workstations, charging-points and more.

Currently undergoing a £500 million development, London City Airport will see a completely new experience delivered to travellers by 2022.

### London City Airport flights

City	Flights per week
Amsterdam	148
Zurich	106
Frankfurt	72
Geneva	38
Berlin	32
Munich	34
Lisbon	24
Warsaw	24

Weekly flights to/from London City Airport (LCY) by city

# Journey times

London City Airport to  
InterContinental  
London O2:

17 minutes by car

21 minutes by public  
transport (DLR and  
Tube)

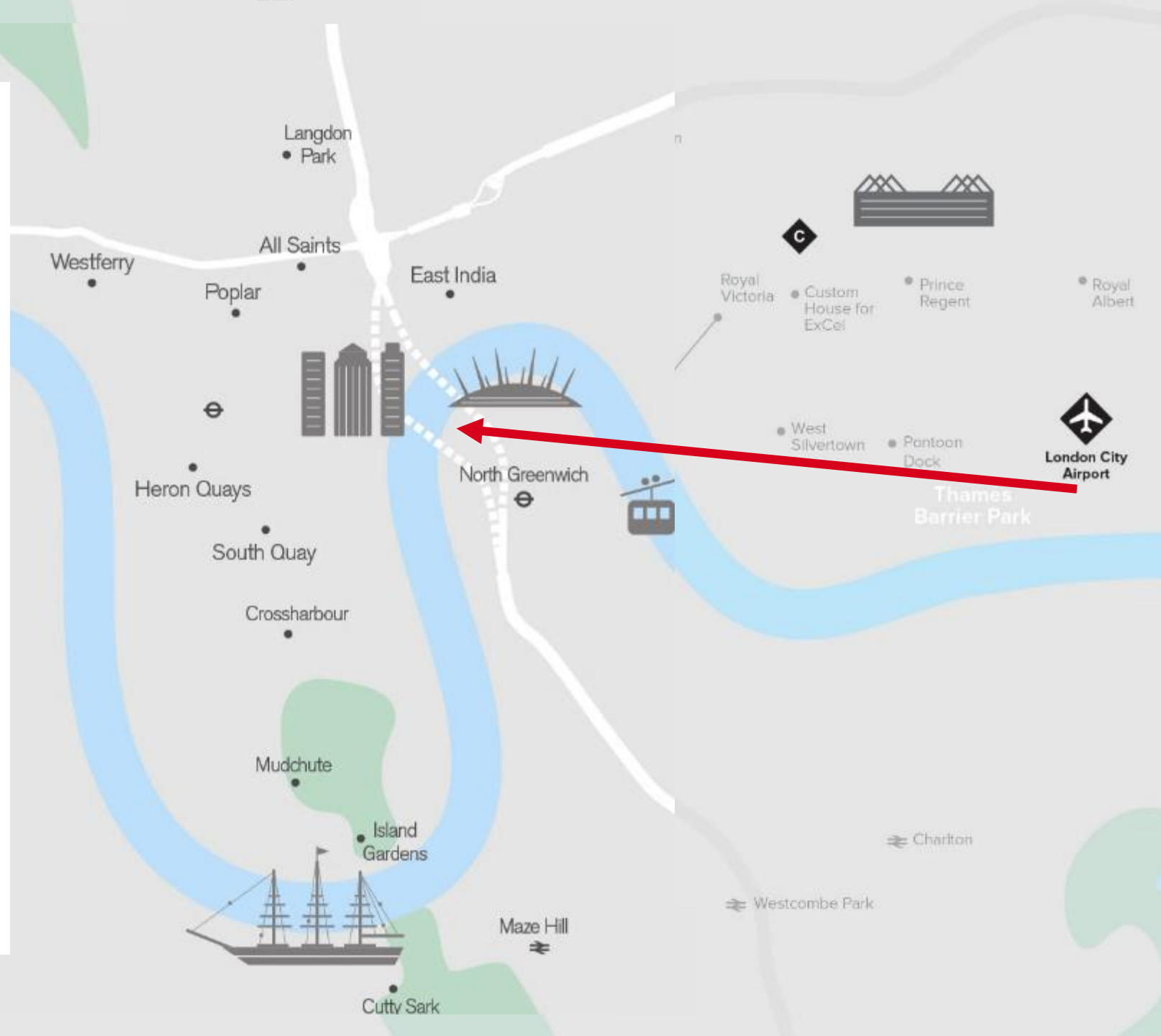

# Tube map

Fare zones: 2 and 3

InterContinental  
London O2 –  
nearest station:  
North Greenwich

Public transport  
served by Jubilee  
and DLR lines.



# Royal Museums Greenwich

Royal Museums Greenwich comprises five unique venues, located in the UNESCO World Heritage site of Maritime Greenwich – Cutty Sark, the National Maritime Museum, the Queen's House, the Royal Observatory Greenwich, the Peter Harrison Planetarium and 10,000 sqm of spacious grounds for an epic backdrop for your event.



# Venues



## **Queen's House**

Host your reception amongst the seventeenth century art gallery.



## **Peter Harrison Planetarium**

Take your delegates to the stars at London's only planetarium.



## **Cutty Sark**

Banquet in the base of the world's only surviving tea clipper.



# Venues



## Royal Observatory

Spend time at the home of Greenwich Mean Time (GMT).



## National Maritime Museum

The naval and nautical museum boasts large spaces for private events.



## Painted Hall

Wow your delegates in the room dubbed as the “Sistine Chapel of the UK”.

# Hotels

From 5-star InterContinental London O2 to affordable DoubleTree by Hilton, Novotel or The Stratford, there is an array of hotels in the capital that will make your stay very comfortable.



# The Stratford

Located close to Greenwich, The Stratford Hotel serves you great views.

Overlooking Queen Elizabeth Olympic Park, guests are surrounded by world-class art, culture and entertainment.

Featuring an all-day brasserie, lounge bar, 24-hour gym, four event spaces and a sky garden, The Stratford is a tranquil urban retreat with a vibrant social spirit. Its 145 rooms blend Scandinavian style with London's fastest 10GB wifi.



**THE  
STRATFORD**

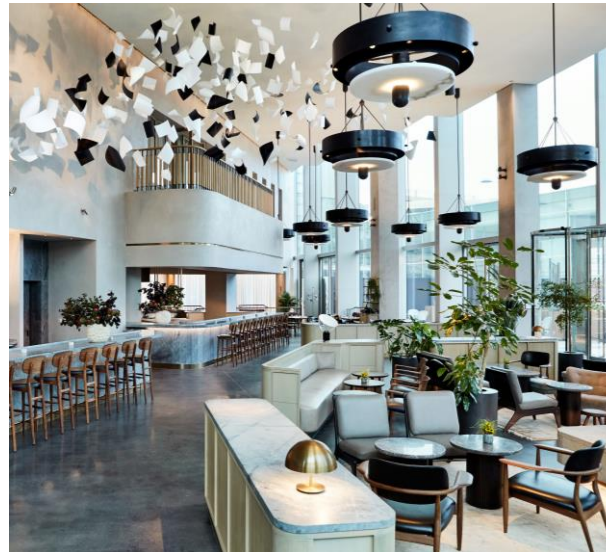

# Activities



## **N1 Golf**

Discover Greenwich Peninsula – the largest golfing academy in Europe.



## **Up at the O2**

Hit the heights and climb over the roof of London's iconic arena.



## **4DX at Cineworld**

Immerse in the first 4DX cinema in London – all senses required.

# Activities



## Meantime Brewing

Test your taste buds with the ultimate beer tour, with beer born in London.



## Gin Masterclass

Embark on the journey of Gin tasting in our exclusive Clipper Bar.



## Museums

Visit the National Maritime Museum, Queens House and the Royal Observatory.

# Activities



## Emirates Air Line

Take a ride in London's only cable car with spectacular views of east London.



## Thames Clippers

Learn more about London's iconic landmarks cruising along the riverside.



## ICON at the O2

Shop for your favourite brands at London's newest designer outlet.

# Activities



## O2 Arena

From sports to music to comedy, this 20,000 seated venue is the world's most popular arena.



## Greenwich Market

Open every day with street food, antiques, fashion and boutique shops. Relax at a local pub afterwards.



## Eltham Palace

19 acres of beautiful gardens and a medieval palace with Tudor royal residence.

A photograph of the National Maritime Museum building in Greenwich, London. The building is a grand, classical-style structure with a central portico supported by columns. A flagpole with the Union Jack stands in front of the building. In the foreground, there is a large field of bright yellow daffodils. An orange text box is overlaid on the left side of the image.

## 3-day itinerary for small to medium conferences



# Day 1

**11:50** Arrival at London City Airport

Quick, 20 minute transfer by coach to conference hotel InterContinental O2

**12:30** Arrival at InterContinental O2 and check-in

**13:00 – 14:30** Group lunch at the lively Market Brasserie

**15:00 – 17:00** Kick-off meeting in the InterContinental O2 'Cutty Sark Suite'

**18:30 – 19:30** Drinks reception at the Cutty Sark

**20:00** Gala dinner in Cutty Sark

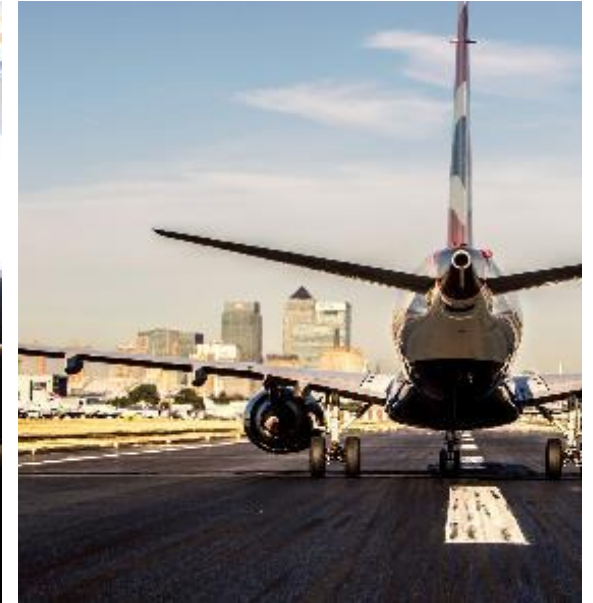

## Day 2

**07:00** Breakfast at the hotel

**09:00 – 13:00** Half a day of meetings

**13:30 – 18:00** Choice of activities (see activities slide)

**19:30** Live concert – O2 Arena  
(options include private box, VIP tickets, private dining)

**23:00 – late** Indigo at the O2  
nightclub VIP Lounge



# Day 3

## See more of London

Explore a different part of London by taking a boat tour from one of Greenwich's peninsulas.

Take a trip along the iconic river Thames into central London, passing many of London's historic and modern buildings, from Tower Bridge and the Houses of Parliament to Canary Wharf and the Shard.





From  
**£598pp**



## Rates

InterContinental at the O2

- Drinks reception
  - Wine
  - Beer
  - Soft drinks
- Dinner
  - Three courses
  - Half bottle of wine
  - Tea and coffee
- Day delegate package
  - Includes room hire, three coffee breaks and buffet lunch
- 2 nights' accommodation
  - Including breakfast

**= from £598pp**

## Day 1

Time	Activity	Location
11:50	Arrival	London City Airport
12:30	Check-in	InterContinental London O2
13:00 – 14:30	Group lunch	Market Brasserie
15:00 – 17:00	Kick-off meeting	InterContinental O2 Cutty Sark Suite
18:30 – 19:30	Drinks reception	Cutty Sark
20:00	Gala dinner	Cutty Sark

## Day 2

Time	Activity	Location
07:00	Breakfast	InterContinental London O2
09:00 – 13:00	Meetings (half day)	InterContinental London O2
13:30 – 18:00	Choice of activities (see activities slide)	Various
19:30	Live concert	O2 Arena
23:00 – late	Nightclub VIP lounge	Indigo at the O2

## Day 3

Time	Activity	Location
11:00	Check out	InterContinental London O2
11:00 onwards	Various	Various

**Turn this itinerary into a reality.**

Contact the London Convention Bureau for more information.

[conventionbureau@londonandpartners.com](mailto:conventionbureau@londonandpartners.com)